

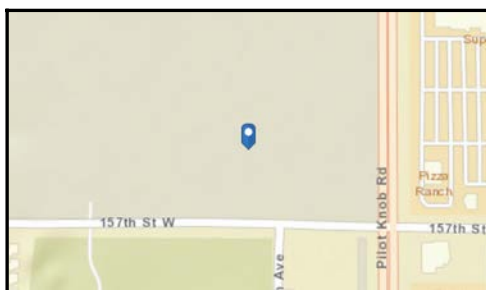

Traffic Count Map - Close Up

Orchard Place
 Apple Valley, Minnesota
 Rings: 1, 3, 5 mile radii

Prepared by HJ Development
 Latitude: 44.72195
 Longitude: -93.17936

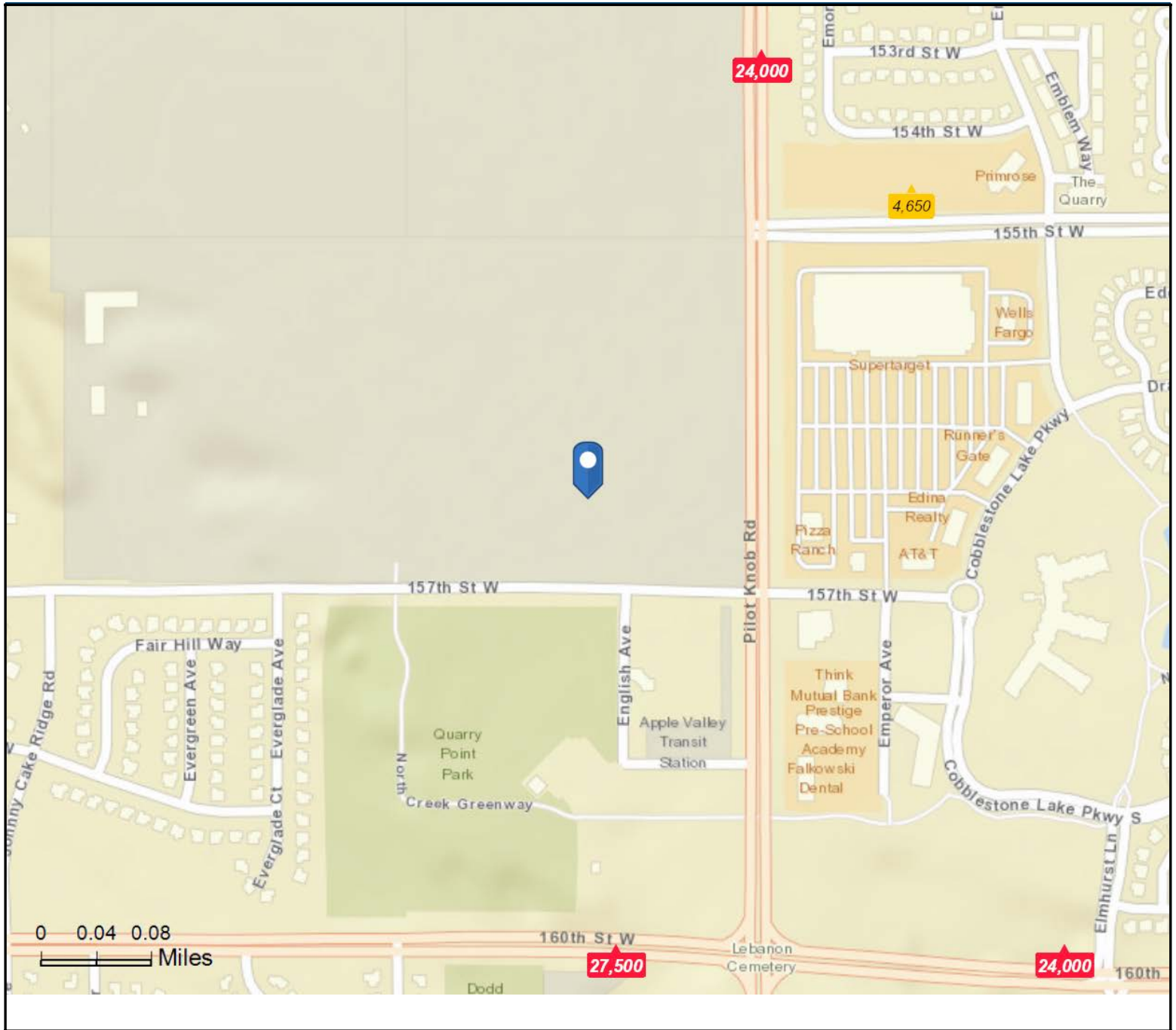

- Average Daily Traffic Volume**
- ▲ Up to 6,000 vehicles per day
 - ▲ 6,001 - 15,000
 - ▲ 15,001 - 30,000
 - ▲ 30,001 - 50,000
 - ▲ 50,001 - 100,000
 - ▲ More than 100,000 per day

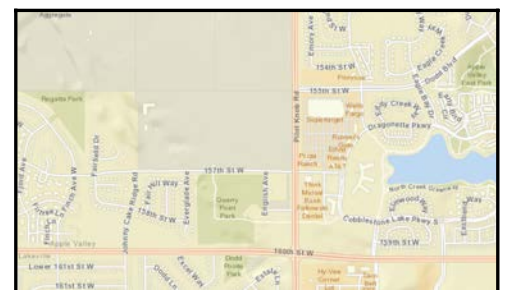

Source: ©2018 Kalibrate Technologies (Q3 2018).

March 06, 2019



Traffic Count Map

Orchard Place
 Apple Valley, Minnesota
 Rings: 1, 3, 5 mile radii

Prepared by HJ Development
 Latitude: 44.72195
 Longitude: -93.17936

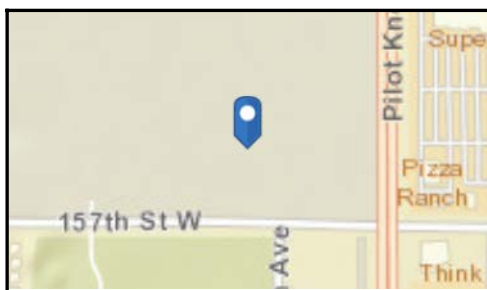
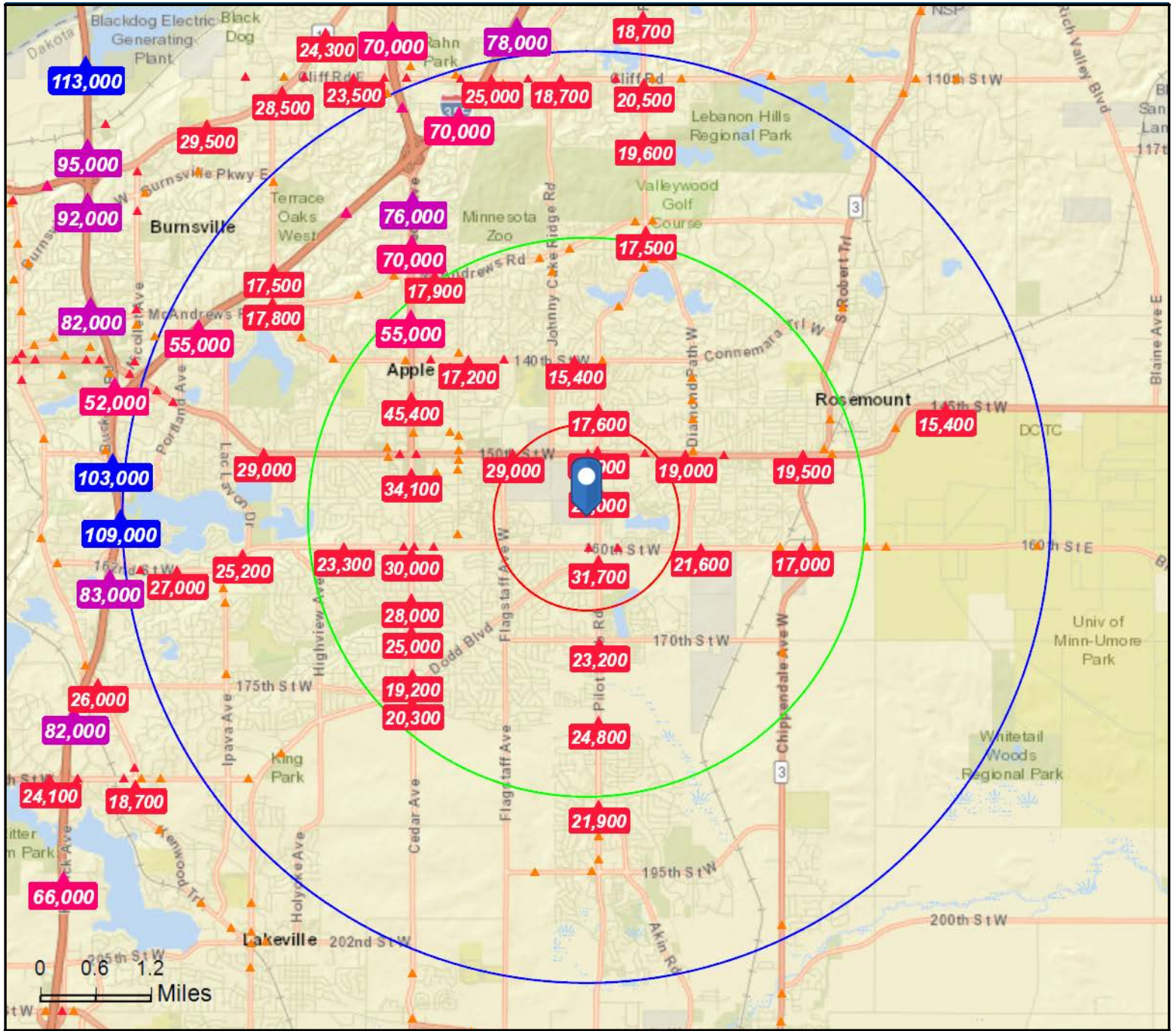

- Average Daily Traffic Volume**
- ▲ Up to 6,000 vehicles per day
 - ▲ 6,001 - 15,000
 - ▲ 15,001 - 30,000
 - ▲ 30,001 - 50,000
 - ▲ 50,001 - 100,000
 - ▲ More than 100,000 per day



Source: ©2018 Kalibrate Technologies (Q3 2018).

March 06, 2019



Traffic Count Profile

Orchard Place
 Apple Valley, Minnesota
 Rings: 1, 3, 5 mile radii

Prepared by HJ Development
 Latitude: 44.72195
 Longitude: -93.17936

Distance:	Street:	Closest Cross-street:	Year of Count:	Count:
0.32	Dodd Blvd	Embry Path (0.1 miles E)	2014	4,650
0.32	160th St W	Dodd Blvd (0.09 miles W)	2016	27,500
0.34	Pilot Knob Rd	Dodd Blvd (0.1 miles S)	2016	24,000
0.46	Dodd Blvd	Dodd Ln (0.09 miles SW)	2011	5,800
0.46	160th St W	Elmhurst Ln (0.03 miles E)	2016	24,000
0.47	Pilot Knob Rd	Dodd Blvd (0.1 miles N)	2015	31,700
0.52	Pilot Knob Rd	Dodd Blvd (0.04 miles S)	2011	29,000
0.55	Dodd Blvd	Pilot Knob Rd (0.11 miles E)	2016	8,000
0.62	Fairgreen Ave	162nd St W (0.02 miles S)	2015	1,500
0.70	150th St W	Pilot Knob Rd (0.1 miles E)	2016	28,000
0.74	Pilot Knob Rd	150th St W (0.03 miles S)	2014	18,900
0.86	157th St W	Flackwood Ave (0.02 miles E)	2014	650
0.88	Finch Way W	162nd St W (0.09 miles NE)	2011	870
0.92	Flagstaff Ave	158th St (0.03 miles N)	2014	4,950
0.93	150th St W	Easter Ave (0.05 miles W)	2011	19,000
1.02	Flagstaff Ave W	Flagstaff Ct N (0.04 miles N)	2015	5,900
1.05	150th St W	Flagstaff Ave (0.1 miles W)	2011	29,000
1.06	153rd St	Flagstaff Ave (0.11 miles E)	2014	1,000
1.07	Flagstaff Ave	150th St W (0.09 miles N)	2014	6,700
1.08	164th St W	Finch Way W (0.03 miles E)	2015	810
1.10	157th St	Foliage Ave (0.03 miles W)	2014	1,450
1.11	Diamond Path	155th St W (0.1500001 miles N)	2014	2,750
1.15	Foliage Ave	158th St (0.04 miles N)	2014	3,500
1.16	Flagstaff Ave	150th St W (0.04 miles S)	2014	7,100
1.16	Dodd Blvd	Dove Trl (0.06 miles E)	2014	3,400
1.18	Diamond Path	155th St W (0.11 miles S)	2014	4,550
1.19	Pilot Knob Rd	144th St (0.1 miles N)	2011	17,600
1.20	Foliage Ave W	162nd Ct (0.03 miles S)	2015	4,400
1.22	164th St W	Forbes Ave W (0.03 miles W)	2015	1,200
1.24	Diamond Path	152nd Street Upper W (0.04 miles S)	2010	4,500

Data Note: The Traffic Profile displays up to 30 of the closest available traffic counts within the largest radius around your site. The years of the counts in the database range from 2018 to 1963. Over 25% of the counts were taken between 2010 and 2018 and over 77% of the counts were taken between 2000 and 2018. Traffic counts are identified by the street on which they were recorded, along with the distance and direction to the closest cross-street. Distances displayed as 0.00 miles (due to rounding), are closest to the site. A traffic count is defined as the two-way Average Daily Traffic (ADT) that passes that location.

Source: ©2018 Kalibrate Technologies (Q3 2018).