

Traffic count map provided by
MNDOT office of Transportation & Data
Analysis (www.dot.state.mn.us).



Traffic Count Map

Cobblestone Target Outlot
15878 Emperor Ave, Saint Paul, Minnesota, 55124
Rings: 1, 3, 5 mile radii

Prepared by HJ Development
Latitude: 44.71917
Longitude: -93.17515

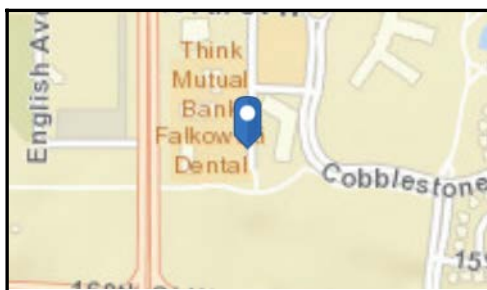
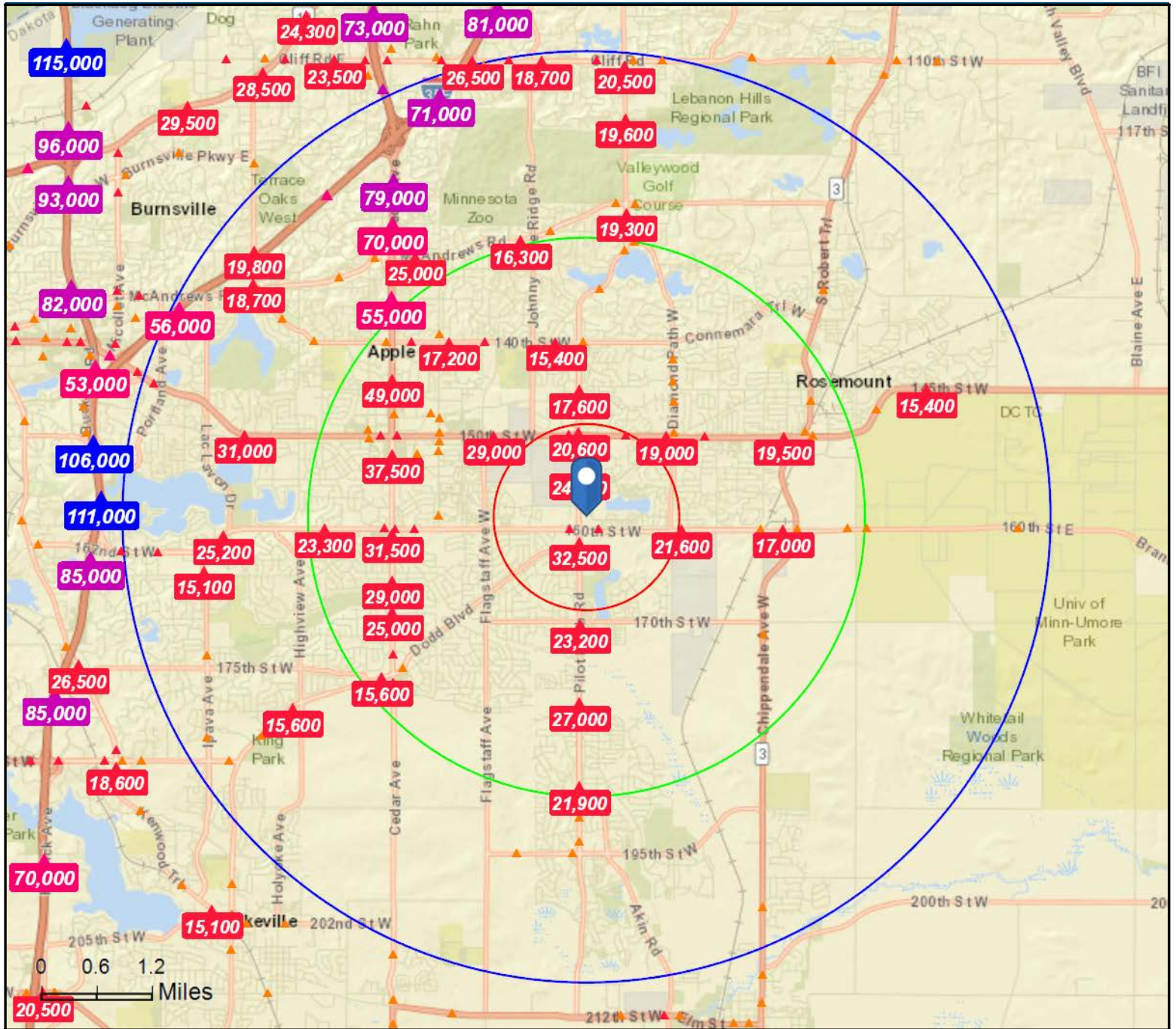

- Average Daily Traffic Volume**
- ▲ Up to 6,000 vehicles per day
 - ▲ 6,001 - 15,000
 - ▲ 15,001 - 30,000
 - ▲ 30,001 - 50,000
 - ▲ 50,001 - 100,000
 - ▲ More than 100,000 per day

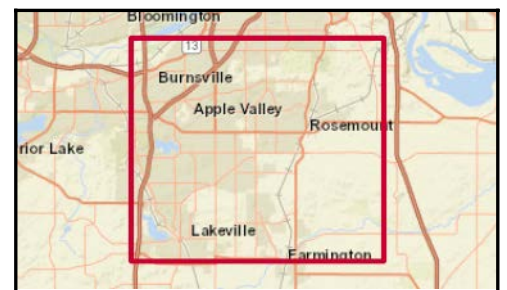

Source: ©2019 Kalibrate Technologies (Q3 2019).

February 07, 2020



Traffic Count Map - Close Up

Cobblestone Target Outlot
15878 Emperor Ave, Saint Paul, Minnesota, 55124
Rings: 1, 3, 5 mile radii

Prepared by HJ Development
Latitude: 44.71917
Longitude: -93.17515

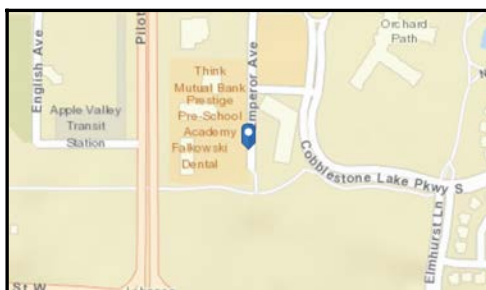
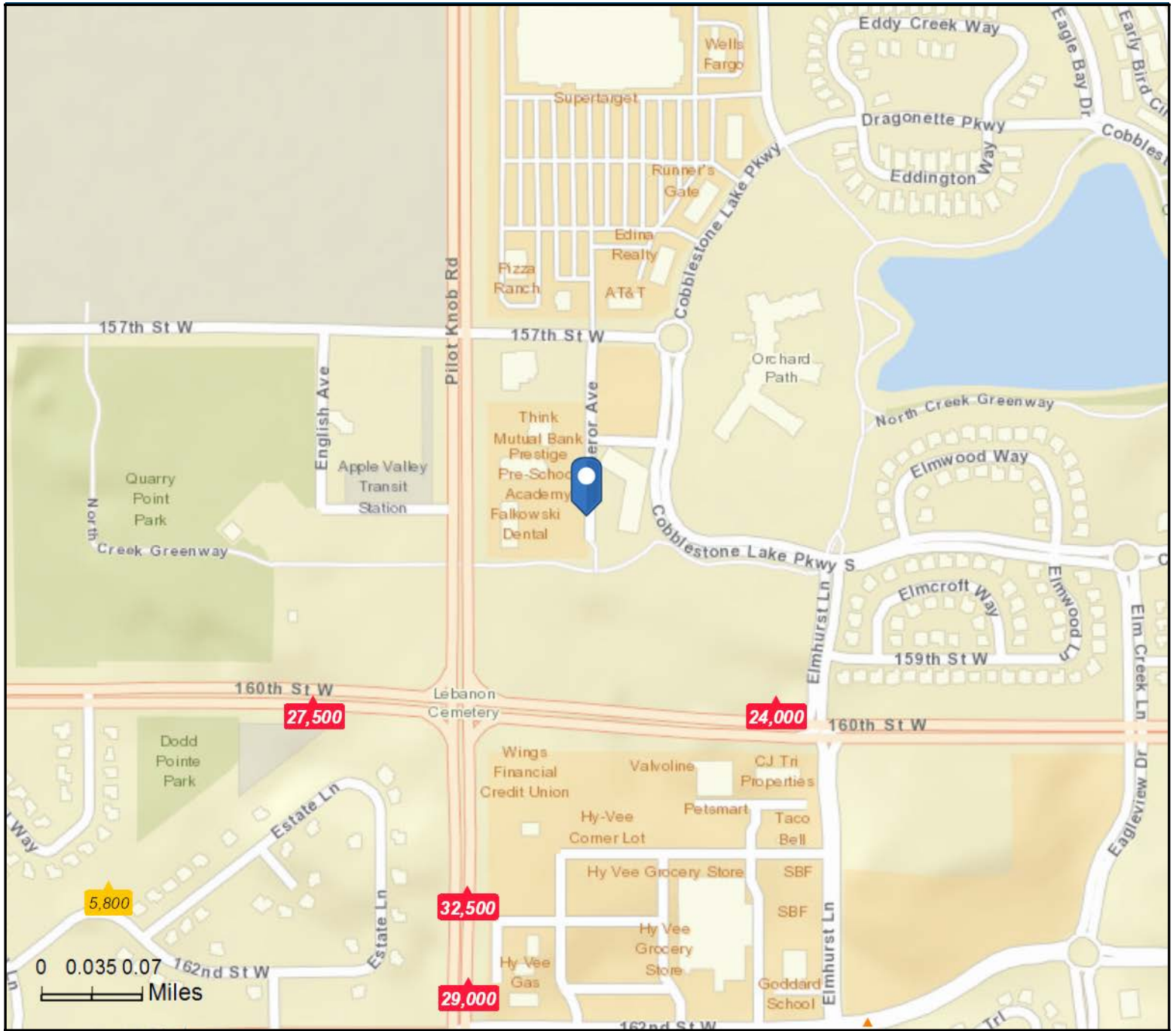

- Average Daily Traffic Volume**
- ▲ Up to 6,000 vehicles per day
 - ▲ 6,001 - 15,000
 - ▲ 15,001 - 30,000
 - ▲ 30,001 - 50,000
 - ▲ 50,001 - 100,000
 - ▲ More than 100,000 per day



Source: ©2019 Kalibrate Technologies (Q3 2019).

February 07, 2020



Traffic Count Profile

Cobblestone Target Outlot
15878 Emperor Ave, Saint Paul, Minnesota, 55124
Rings: 1, 3, 5 mile radii

Prepared by HJ Development
Latitude: 44.71917
Longitude: -93.17515

Distance:	Street:	Closest Cross-street:	Year of Count:	Count:
0.18	160th St W	Elmhurst Ln (0.03 miles E)	2016	24,000
0.23	160th St W	Dodd Blvd (0.09 miles W)	2016	27,500
0.27	Pilot Knob Rd	Dodd Blvd (0.1 miles N)	2017	32,500
0.33	Pilot Knob Rd	Dodd Blvd (0.04 miles S)	2011	29,000
0.40		(0.0 miles)	2017	13,900
0.41	Dodd Blvd	Pilot Knob Rd (0.11 miles E)	2016	8,000
0.41	Dodd Blvd	Embry Path (0.1 miles E)	2014	4,650
0.41	Dodd Blvd	Dodd Ln (0.09 miles SW)	2011	5,800
0.51	Pilot Knob Rd	Dodd Blvd (0.1 miles S)	2016	24,000
0.67	Fairgreen Ave	162nd St W (0.02 miles S)	2017	2,450
0.88	Eagleview Dr	Dynamic Dr (0.04 miles SW)	2017	750
0.91	150th St W	Pilot Knob Rd (0.1 miles E)	2016	28,000
0.92	Pilot Knob Rd	150th St W (0.03 miles S)	2017	20,600
0.94	Diamond Path	155th St W (0.15000001 miles N)	2017	3,000
0.95	Finch Way W	162nd St W (0.09 miles NE)	2011	870
0.97	150th St W	Easter Ave (0.05 miles W)	2011	19,000
1.02	160th St W	Danville Ave W (0.08 miles E)	2016	21,600
1.06	Diamond Path	155th St W (0.11 miles S)	2017	4,900
1.07	157th St W	Flackwood Ave (0.02 miles E)	2014	650
1.09	Flagstaff Ave	158th St (0.03 miles N)	2014	4,950
1.11	Dodd Blvd	Dove Trl (0.06 miles E)	2014	3,400
1.12	170th St W	Embers Ave (0.02 miles W)	2015	5,600
1.13	170th St W	Pilot Knob Rd (0.11 miles E)	2015	4,800
1.13	Flagstaff Ave W	Flagstaff Ct N (0.04 miles N)	2017	6,800
1.15	Pilot Knob Rd	170th St W (0.03 miles N)	2016	23,200
1.15	164th St W	Finch Way W (0.03 miles E)	2017	1,150
1.16	Diamond Path	152nd Street Upper W (0.04 miles S)	2010	4,500
1.23	150th St W	Dove Trl (0.06 miles W)	2016	19,000
1.25	170th St W	Fairhill Ave (0.01 miles E)	2011	5,000
1.30	Diamond Path W	Diamond Path (0.03 miles S)	2016	8,400

Data Note:The Traffic Profile displays up to 30 of the closest available traffic counts within the largest radius around your site. The years of the counts in the database range from 2019 to 1963. Over 25% of the counts were taken between 2010 and 2019 and over 77% of the counts were taken between 2000 and 2019. Traffic counts are identified by the street on which they were recorded, along with the distance and direction to the closest cross-street. Distances displayed as 0.00 miles (due to rounding), are closest to the site. A traffic count is defined as the two-way Average Daily Traffic (ADT) that passes that location.

Source: ©2019 Kalibrate Technologies (Q3 2019).