

MAPLEWOOD TOWN CENTER

East County Road D & White Bear Avenue | Maplewood, MN 55109



MAPLEWOOD TOWN CENTER

Maplewood Town Center is a multi-tenant retail development. Constructed in 1987, the 109,169 sf center was remodeled in 2012/2013 to accommodate the addition of DSW and OfficeMax. Maplewood Town Center is located off of I-694 at the intersection of White Bear Avenue & East County Road D. The center is easily accessible and visible from I-694. For more information or to schedule a property tour please contact us directly.

DEMOGRAPHICS (Data Source - ESRI)

	<u>1-Mile</u>	<u>3-Miles</u>	<u>5-Miles</u>
Population:	6,195	66,001	193,759
Daytime Population:	9,893	37,813	76,377
Households:	2,654	26,794	74,310
Average HH Income:	\$85,369	\$90,087	\$88,218

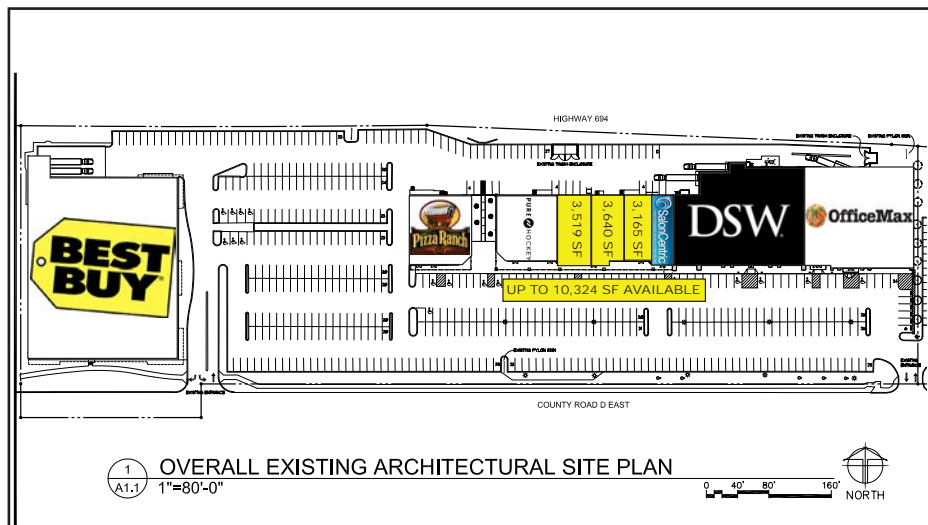

AVAILABLE FOR LEASE

- 3,519 sf In-Line Space
- Former Mattress Retailer
- Negotiable Rates & TI's
- Immediate Occupancy Available

- 3,640 sf In-Line Space
- Occupied by a Flooring Retailer
- Negotiable Rates, TI's & Occupancy

- 3,165 sf In-Line Space
- Former Paint Retailer
- Negotiable Rates & TI's
- Immediate Occupancy Available

- Up to 10,324 SF May Be Available
Call for Details

CONTACT INFORMATION

- ✉ **Chris Moe, CCIM:**
cmoe@hjdevelopment.com
- ✉ **Brian Merz:**
bmerz@hjdevelopment.com
- 📞 952-476-9400
- 🌐 www.hjdevelopment.com

MAPLEWOOD TOWN CENTER

East County Road D & White Bear Avenue | Maplewood, MN 55109

