

MAPLEWOOD TOWN CENTER

East County Road D & White Bear Avenue | Maplewood, MN 55109



MAPLEWOOD TOWN CENTER

Maplewood Town Center is a multi-tenant retail development. Constructed in 1987, the 109,169 SF center was remodeled in 2012/2013 to accommodate the addition of DSW and OfficeMax. Maplewood Town Center is located off of I-694 at the intersection of White Bear Avenue & East County Road D. The center is easily accessible and visible from I-694. For more information or to schedule a property tour please contact us directly.

DEMOGRAPHICS (Data Source - ESRI)

	<u>1-Mile</u>	<u>3-Miles</u>	<u>5-Miles</u>
Population:	6,953	67,472	198,262
Daytime Population:	11,375	37,306	77,986
Households:	2,997	27,429	75,205
Average HH Income:	\$109,083	\$107,385	\$104,341

AVAILABLE FOR LEASE

- 3,476 SF Available
- In-Line Location
- Negotiable Rates & TI's
- Immediate Occupancy Available
- Ideal Location for a Variety of Uses

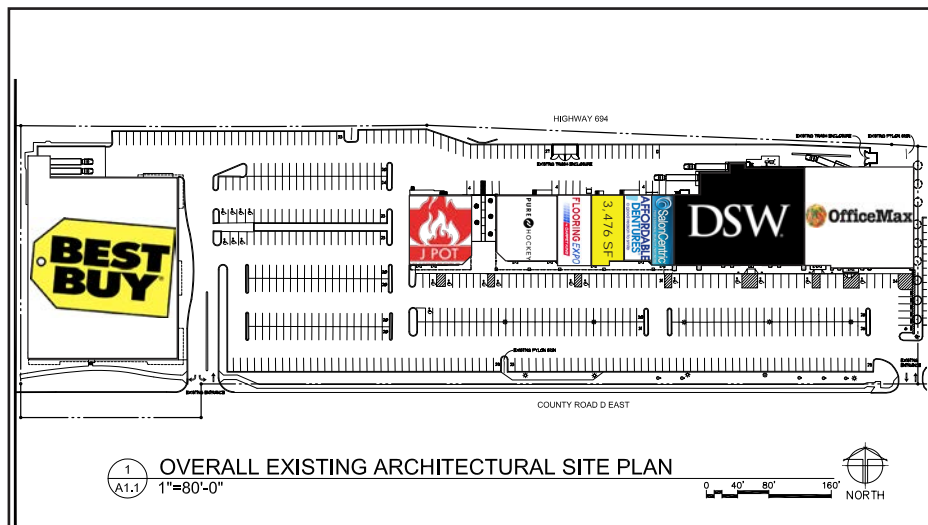

CONTACT INFORMATION

- ✉ **Chris Moe, CCIM:**
cmoe@hjdevelopment.com
- ✉ **Brian Merz:**
bmerz@hjdevelopment.com
- 📞 952-476-9400
- 🌐 www.hjdevelopment.com

MAPLEWOOD TOWN CENTER

East County Road D & White Bear Avenue | Maplewood, MN 55109

