

RIDGEWOOD CENTER

Ridgedale Drive & Essex Road | Minnetonka, MN 55305



RIDGEWOOD CENTER

HJ Development is actively marketing Ridgewood Center a 30,000 SF retail property located within the sought-after Ridgedale Trade Area, a main shopping destination for the western suburbs. The center is easily accessible with frontage along I-394, provides ample parking, and has prominent building & pylon signage. For more information or to schedule a property tour please contact us directly.

DEMOGRAPHICS (Data Source - ESRI)

	<u>1-Mile</u>	<u>3-Miles</u>	<u>5-Miles</u>
Population:	6,403	49,854	174,808
Daytime Population:	15,173	73,146	162,288
Households:	3,110	22,683	76,784
Average HH Income:	\$163,139	\$150,238	\$138,758

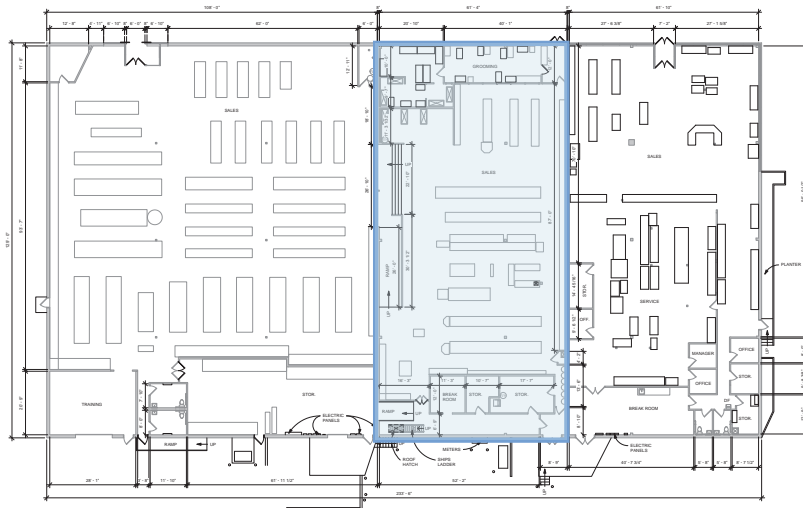

AVAILABLE FOR LEASE

- Up to 12,000 Contiguous SF Available
- Negotiable Rates & TI's
- Tour Today; Negotiable Occupancy
- User-Driven Development
- Ideal Location for a Variety of Retail, Medical Office & Service Related Businesses
- Area Retailers Include: Best Buy, Target, Slumberland, Lunds & Byerly's, Hobby Lobby, OfficeDepot, Whole Foods, Total Wine, Goodwill, and Ridgedale Mall

CONTACT INFORMATION

- ✉ **Chris Moe, CCIM:**
cmoe@hjdevelopment.com
- ✉ **Brian Merz:**
bmerz@hjdevelopment.com
- 📞 952-476-9400
- 🌐 www.hjdevelopment.com

RIDGEWOOD CENTER

Ridgedale Drive & Essex Road | Minnetonka, MN 55305

